

**PLAN SHOWING THE PROPOSED LAYOUT OF "IRAIVAN NAGAR" AT S.F. NOS : 30 / 3 ,
30 / 5 AND 30 / 7 IN ANTHANAPETTAI VILLAGE , NAGAPPATTINAM DISTRICT .**

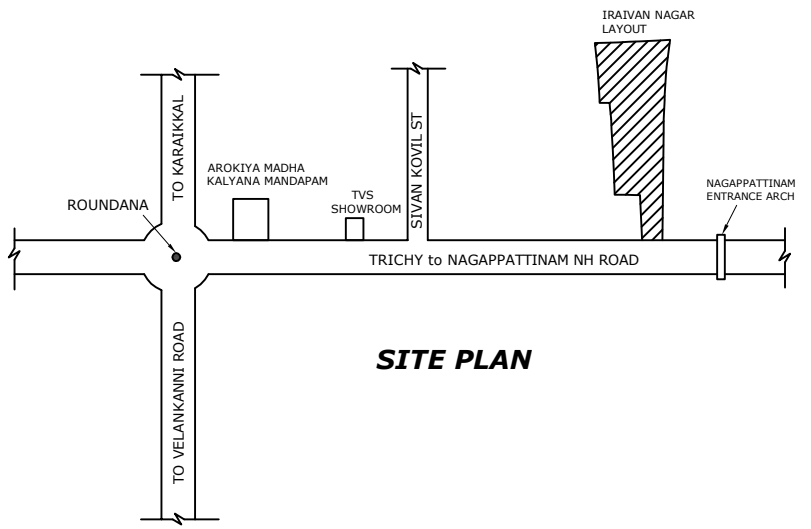
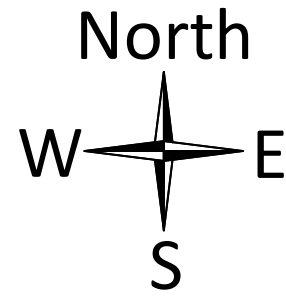
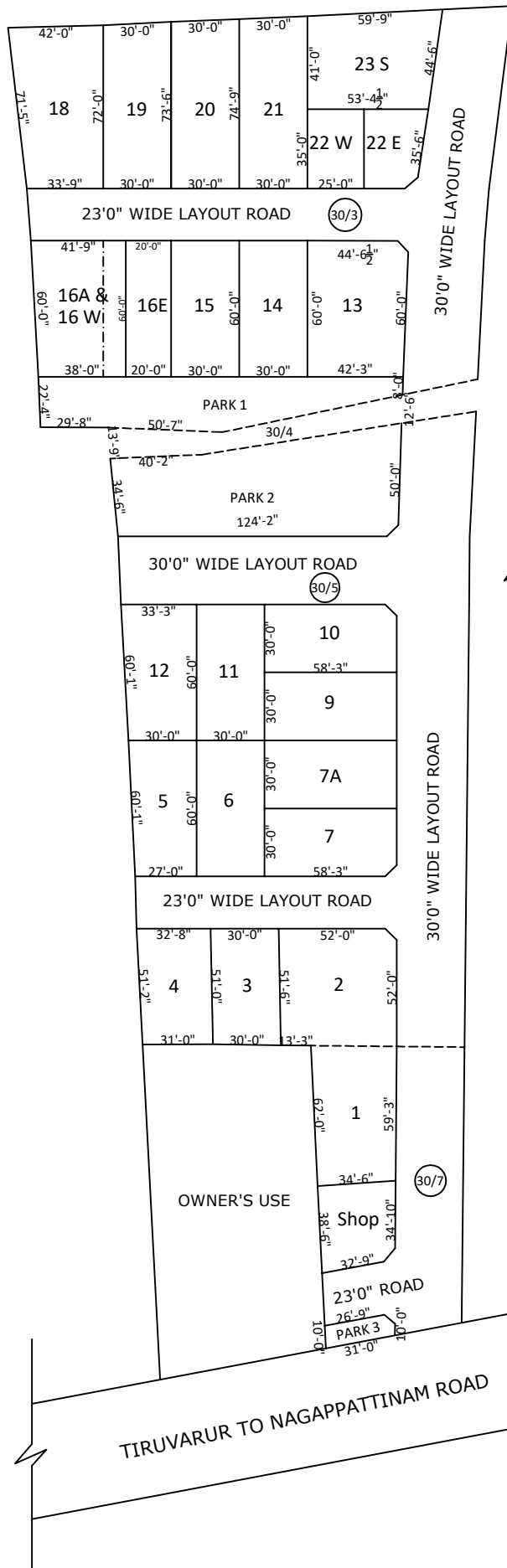

SITE PLAN

PLOT NO	AREA in Sq.Ft	PLOT NO	AREA in Sq.Ft
1	2190.08	13	2597.50
2	2652.63	14	1800.00
3	1537.50	15	1800.00
4	1625.97	16E	1200.00
5	1711.28	16A&16W	2415.00
6	1800.00	18	2715.94
7	1735.00	19	2182.50
7A	1747.50	20	2223.75
9	1747.50	21	2261.25
10	1735.00	22	1686.11
11	1800.00	23	2415.67
12	1898.81	Shop	1220.36
PARK 1		3148 Sq.Ft	
PARK 2		5102 Sq.Ft	
PARK 3		301.25 Sq.Ft	